

CUSTOMER: _____

JOB NAME: _____

PO #: _____ QUOTE # _____

DATE: _____ QUANTITY: L _____ R _____

SHIP TO: _____

One Signature Required

PLUMBING CONTRACTOR APPROVAL _____ /_____/_____
DATE

GENERAL CONTRACTOR APPROVAL _____ /_____/_____
DATE

ENGINEER APPROVAL _____ /_____/_____
DATE

ARCHITECT APPROVAL _____ /_____/_____
DATE

To complete your order, this document must be signed and emailed to the Centralized Customer Service Center.
quotes@americanbathgroup.com • 800.443.7269

STANDARD FEATURES

- Pre-leveled base
- AcrylX™ applied acrylic surface
- 1/2" skirt
- 1/2" COL exterior threshold
- Compliant when properly installed
- Center front drain outlet
- Integral front trench drain
- 12" x 24" subway tile
- Slip resistant, textured bottom [ASTM F-462]

Int. Dim.	60 W x 34 D x 76 3/4 H
Ext. Dim.	66 W x 36 1/8 D x 78 3/4 H
Skirt Ht.	1/2 skirt, 1/2 COL exterior threshold
Packaged Wt.	210 lbs.
Material	AcrylX™ applied acrylic
Warranty	30-year warranty*

* See terms and conditions for details

inches

CONFIGURATION (handed by the seat)

- Shell reinforced for future accessory installation
 - Seat Wall LH RH
 - Optional vertical bar reinforcement (entry wall)
 - LH RH Both
- Fully configured — ADA/ANSI
 - Seat Wall (must choose one) LH RH
 - Includes one stainless steel 24" x 1 1/2" grab bar located on the side wall, one stainless steel 30" x 1 1/2" grab bar located on the back wall, stainless steel grate and cushioned, white, L-shaped fold-up seat, per ADA/ANSI guidelines. (std config)
 - Factory-installed plumbing options per ADA requirements
 - Hand-held shower assembly, 30" slide bar and 60" hose
 - Pressure balancing mixing valve

OPTIONAL ACCESSORIES (available for all models)

- Stainless steel vertical bar 24" x 1 1/2" (entry wall)
 - LH RH Both
- Large soap dish (12 1/2 W x 3 1/2 D x 1 1/2 H), shipped loose
- Small soap dish (7 W x 3 1/2 D x 1 1/2 H), shipped loose
- Curtain rod, shipped loose
- Shower curtain, shipped loose
- Brass drain
- Colors:
 - Standard White
 - Upgraded Biscuit Bone
 - Other (contact customer service for custom color options)
- Additional accessories:

CUSTOM OPTIONS (not avail. if ADA/ANSI configuration is selected)

- Handed by the seat LH RH
- Reinforced for future seat installation
- L-shaped fold-up seat
 - Cushioned white Phenolic teak Phenolic white
- Grab bars:
 - Horizontal L-shaped bars: 24" (side wall) and 30" (back wall)
 - LH RH
 - Vertical bar 24" (entry wall) LH RH Both
- Grab Bar finish:
 - Stainless steel (1 1/2" dia.)
 - Powder-coated white (1 1/4" dia.)
- Factory-installed plumbing options per ADA requirements
 - Hand-held shower assembly, 30" slide bar and 60" hose
 - Pressure balancing mixing valve
- Grate:
 - Stainless steel
 - White

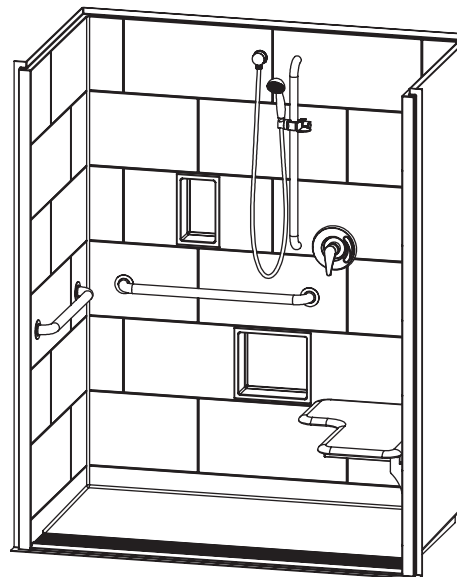

Right hand configuration shown with optional soap dish

This unit is not suitable for behavioral health applications.



ADA/ANSI compliant when fully equipped and installed according to guidelines.



This unit is not suitable for behavioral health applications.

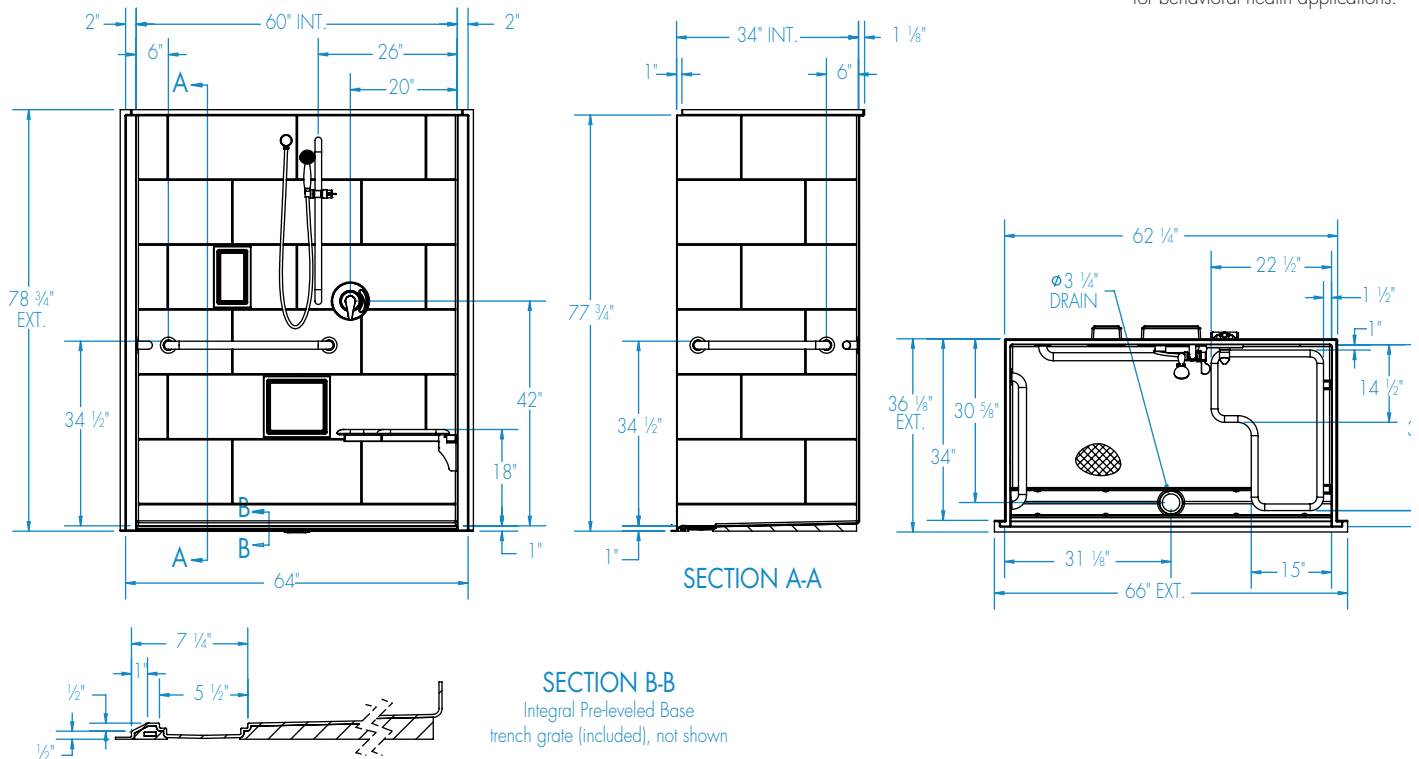

FEATURES lbs Dimensional Tolerance $\pm \frac{3}{8}$ ". Dimensions needed for site preparation should be measured from the unit. Manufacturer assumes no responsibility for preparatory work.

Type and Model #	Material	Wall Finish	Pieces	Drain	Dam/Skirt Height	Net Wt.	Pkg. Wt.
Shower XST6236TR COL	AcrylX™ applied acrylic	Smooth tile	1	Center Front	$\frac{1}{2}$ " skirt $\frac{1}{2}$ " exterior COL threshold	200	210

DIMENSIONS

Specifications	inches (mm)
Width: Ext. / Int.	66 / 60
Depth: Ext. / Int.	36 $\frac{1}{8}$ / 34
Height: Ext. / Int.	78 $\frac{3}{4}$ / 76 $\frac{3}{4}$
Enclosure Opening:	60
Skirt Height:	$\frac{1}{2}$
Drain Rough-In (from Back Wall)	30 $\frac{3}{8}$
Drain Rough-In (from Side Wall)	31 $\frac{1}{8}$

FRAMING DIMENSIONS inches (mm)

Type	D Depth	W Width	H Height	A	B	C
Alcove	34	62 $\frac{1}{4}$	-	Box Out	31 $\frac{1}{8}$	30 $\frac{3}{8}$

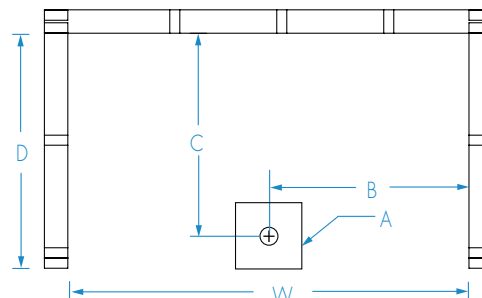

EMAIL TO THE CENTRALIZED CUSTOMER SERVICE CENTER: quotes@americanbathgroup.com

Curtain Rod and Soap Dish Locations (Standard Valve Configuration)

