

CUSTOMER: \_\_\_\_\_

JOB NAME: \_\_\_\_\_

PO #: \_\_\_\_\_ QUOTE # \_\_\_\_\_

DATE: \_\_\_\_\_ QUANTITY: L \_\_\_\_\_ R \_\_\_\_\_

SHIP TO: \_\_\_\_\_

One Signature Required

PLUMBING CONTRACTOR APPROVAL \_\_\_\_\_ /\_\_\_\_\_/\_\_\_\_\_  
DATE

GENERAL CONTRACTOR APPROVAL \_\_\_\_\_ /\_\_\_\_\_/\_\_\_\_\_  
DATE

ENGINEER APPROVAL \_\_\_\_\_ /\_\_\_\_\_/\_\_\_\_\_  
DATE

ARCHITECT APPROVAL \_\_\_\_\_ /\_\_\_\_\_/\_\_\_\_\_  
DATE

To complete your order, this document must be signed and emailed to the Centralized Customer Service Center.  
**quotes@americanbathgroup.com • 800.443.7269**

**STANDARD FEATURES**

- Pre-leveled base
- AcrylX™ applied acrylic surface
- 1 1/8" skirt
- Compliant when properly installed
- Center front drain outlet
- Integral front trench drain
- 12" x 24" subway tile
- Slip resistant, textured bottom [ASTM F-462]

Int. Dim.	60 W x 34 D x 76 5/8 H
Ext. Dim.	62 1/4 W x 36 1/8 D x 78 3/4 H
Skirt Ht.	1 1/8" skirt
Packaged Wt.	210 lbs.
Material	AcrylX™ applied acrylic
Warranty	30-year warranty*

\* See terms and conditions for details

inches

**CONFIGURATION (handed by the seat)**

- Shell reinforced for future accessory installation  
Seat Wall  LH  RH
- Optional vertical bar reinforcement (entry wall)  
 LH  RH  Both
- Fully configured — ADA/ANSI  
Seat Wall (must choose one)  LH  RH  
Includes one stainless steel 24" x 1 1/2" grab bar located on the side wall, one stainless steel 30" x 1 1/2" grab bar located on the back wall, stainless steel grate and cushioned, white, L-shaped fold-up seat, per ADA/ANSI guidelines. (std config)
- Factory-installed plumbing options per ADA requirements  
 Hand-held shower assembly, 30" slide bar and 60" hose  
 Pressure balancing mixing valve

**OPTIONAL ACCESSORIES (available for all models)**

- Stainless steel vertical bar 24" x 1 1/2" (entry wall)  
 LH  RH  Both
- Large soap dish (12 1/2 W x 3 1/2 D x 1 1/2 H), shipped loose
- Small soap dish (7 W x 3 1/2 D x 1 1/2 H), shipped loose
- Curtain rod, shipped loose
- Shower curtain, shipped loose
- Brass drain
- Colors:  
Standard  White  
Upgraded  Biscuit  Bone  
 Other (contact customer service for custom color options)
- Additional accessories:

**CUSTOM OPTIONS (not avail. if ADA/ANSI configuration is selected)**

- Handed by the seat  LH  RH
- Reinforced for future seat installation
- L-shaped fold-up seat  
 Cushioned white  Phenolic teak  Phenolic white
- Grab bars:  
 Horizontal L-shaped bars: 24" (side wall) and 30" (back wall)  
 LH  RH  
 Vertical bar 24" (entry wall)  LH  RH  Both
- Grab Bar finish:  
 Stainless steel (1 1/2" dia.)  
 Powder-coated white (1 1/4" dia.)
- Factory-installed plumbing options per ADA requirements  
 Hand-held shower assembly, 30" slide bar and 60" hose  
 Pressure balancing mixing valve
- Grate:  
 Stainless steel  
 White

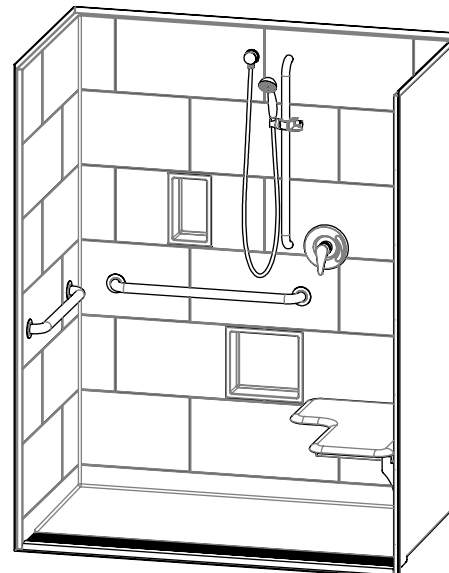

Right hand configuration  
shown with optional soap dish

This unit is not suitable for behavioral health applications.



ADA/ANSI compliant when fully equipped and installed according to guidelines.



This unit is not suitable for behavioral health applications.

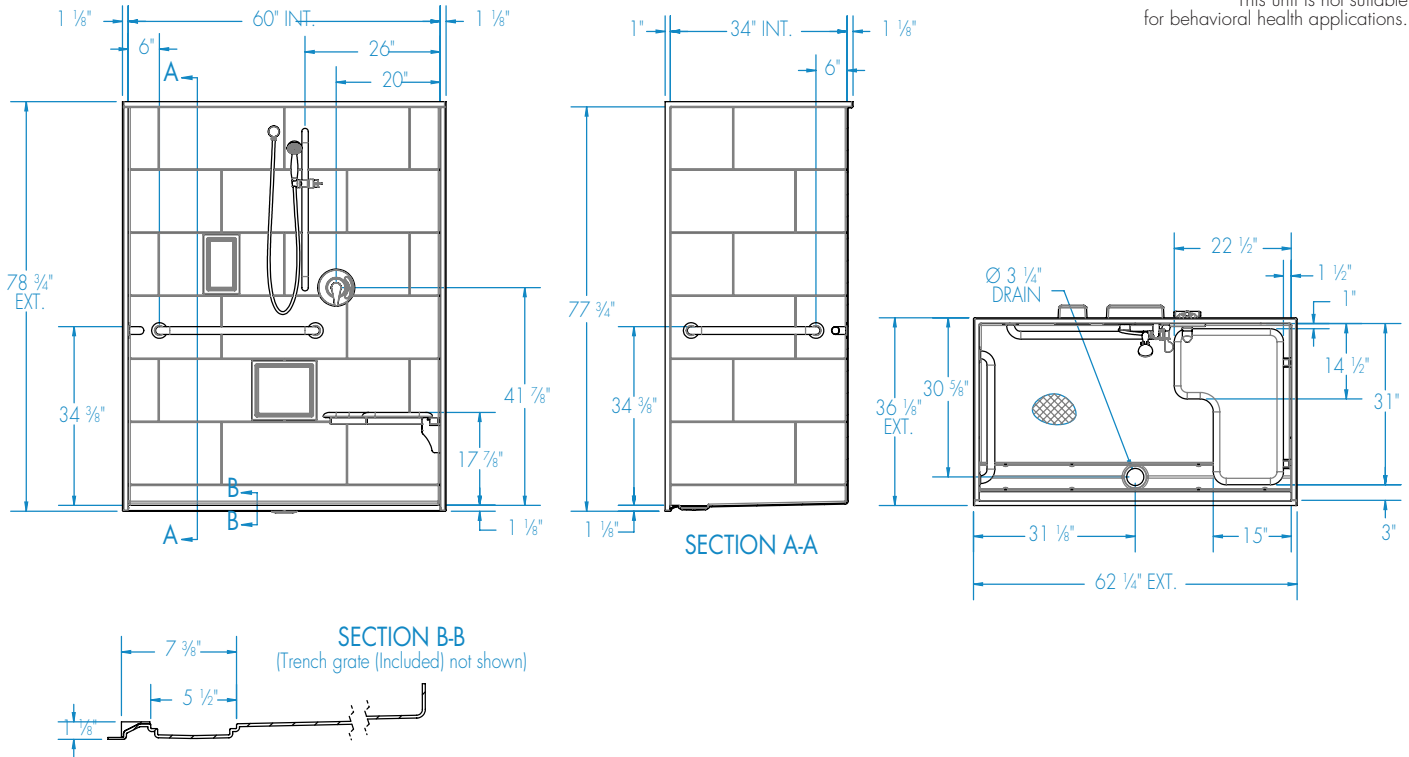

**FEATURES** 1bs Dimensional Tolerance  $\pm \frac{3}{8}$ ". Dimensions needed for site preparation should be measured from the unit. Manufacturer assumes no responsibility for preparatory work.

Type and Model #	Material	Wall Finish	Pieces	Drain	Dam/Skirt Height	Net Wt.	Pkg. Wt.
Shower XST6034TR 1.125	AcrylX™ applied acrylic	Smooth tile	1	Center Front	1 1/8" skirt	200	210

**DIMENSIONS**

Specifications	inches
Width: Ext. / Int.	62 1/4 / 60
Depth: Ext. / Int.	36 1/8 / 34
Height: Ext. / Int.	78 3/4 / 76 5/8
Enclosure Opening:	60
Skirt Height:	1 1/8
Drain Rough-In (from Back Wall)	30 5/8
Drain Rough-In (from Side Wall)	31 1/8

**FRAMING DIMENSIONS** inches (mm)

Type	D Depth	W Width	H Height	A	B	C
Alcove	36 1/8	62 1/2	-	Box Out	31 1/8	30 5/8

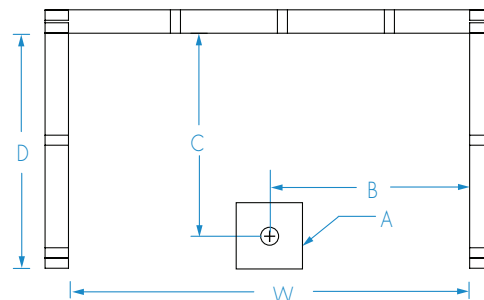

EMAIL TO THE CENTRALIZED CUSTOMER SERVICE CENTER: [quotes@americanbathgroup.com](mailto:quotes@americanbathgroup.com)